



# Sanabad Shopping Center

ARSH 4D Studio

RESIDENTIAL	SENIOR	2015	> 100+ M2	SMALL BUILDING	SMALL COMPLEX	TEHRAN	COMPLETED	1ST PRIZE
COMMERCIAL	PROJECT MANAGER	2014	> 1,000+ M2	MEDIUM BUILDING	MEDIUM COMPLEX	IRAN	UNDER CONSTRUCTION	2ND PRIZE
CULTURAL	ARCHITECT	2013	> 10,000+ M2	LARGE BUILDING	LARGE COMPLEX	OTHER COUNTRIES	COMPETITION	3RD PRIZE
OFFICE	3D DESIGNER	2012	> 100,000+ M2	INTERIOR	X-LARGE COMPLEX		CANCELED	HONORABLE MENTION
PUBLIC		2011						



36° 18' 03" N - 59° 35' 03" E

The project was to design a small shop for the products of Samsung in Mashhad.

We proposed different alternatives to make the façade interactive. Such as using the client commercial logo on the façade pattern, or providing some openings in the façade to broaden the view to the city.

Mashhad, Iran, Professional Project, 2,280 sqm  
Arsh[4D] Design Studio  
2014

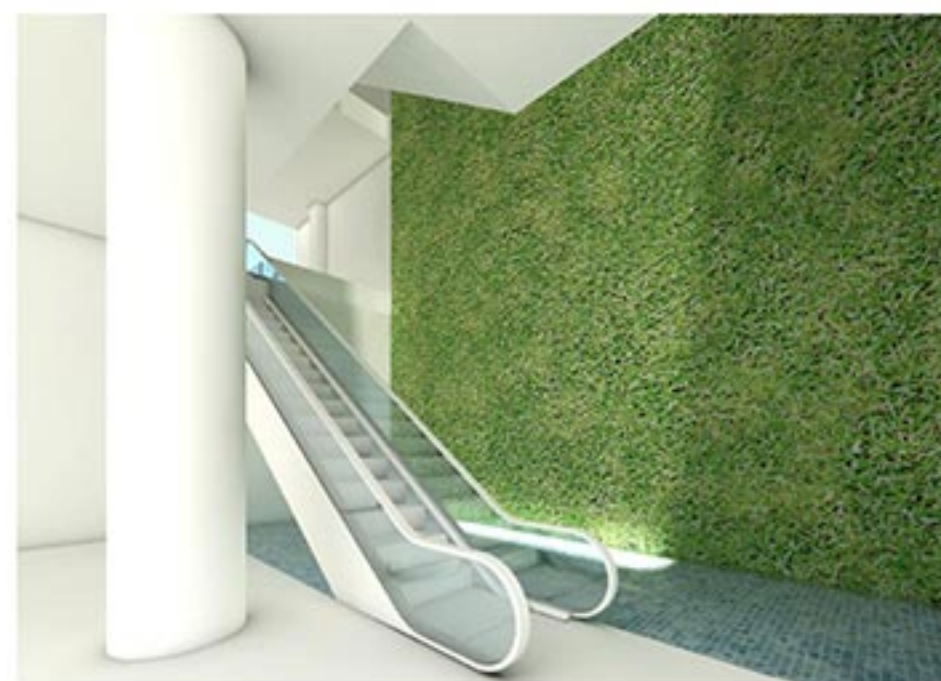

#### Responsibility :

Responsible for Designing Facade four alternatives for the façade and designed the Parametric Punched Facade in Grasshopper.  
Project Manager in schematic design and design development. Also responsible for Modeling, Rendering and Post Production.

